



Whilst every effort is made to give a fair description, the accuracy of these particulars is not guaranteed, neither do they constitute an offer or contract.

**MATHESONS ESTATE AGENTS** have not tested any apparatus, equipment, fitting or services and so cannot verify that they are in working order. The buyer is advised to obtain verification from their solicitor or surveyor. Measurements are correct to within +/- 6 A sonic tape is used. None of the statements contained in these particulars or any of our properties are to be relied upon as a representation of fact.

166 Manor Park Road  
Harlesden  
London  
NW10 4JT  
T: 020 8965 2250  
E: sales@mathesonsestates.com  
www.mathesonsestates.com



## Bolton Road, Harlesden, London NW10 4BG

### Asking Price £325,000 Leasehold - Share of Freehold



#### KEY FEATURES:

- ONE DOUBLE BEDROOM VICTORIAN FLAT
- GROUND FLOOR
- GOOD ORDER THROUGHOUT
- CLOSE TO LOCAL AMENITIES
- NO UPPER CHAIN
- PRIVATE REAR GARDEN
- SHARE OF FREEHOLD

CHURCHILLMATHESONS are offering this SPACIOUS Victorian GROUND FLOOR end of terraced one bedroom conversion flat, located on this quiet residential road. Benefits include a double bedroom, bright reception room, REFITTED KITCHEN & BATHROOM, COURTYARD REAR GARDEN, SHARE OF THE FREEHOLD. Ideal for the First Time Buyer or for investment a viewing is a MUST.

Close to shops & amenities such as Tesco, Argos and Superdrug with bus links on Craven Park Road. Willesden Junction Station (Zone 2 Bakerloo Line, London Overground) is a short walk away and offers links into Central London.

The property comprises of; Entrance Hall, Bay Fronted Bedroom, Lounge, Kitchen/Diner, Family Bathroom, Rear Garden.

GROUND FLOOR  
482 sq.ft. (44.8 sq.m.) approx.

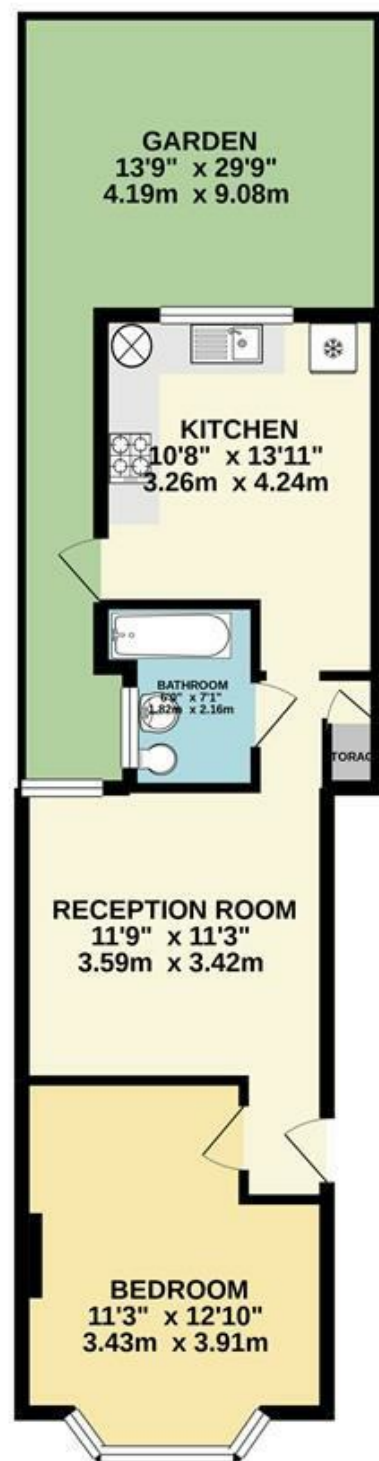

TOTAL FLOOR AREA : 482 sq.ft. (44.8 sq.m.) approx.

Whilst every attempt has been made to ensure the accuracy of the floorplan contained here, measurements of doors, windows, rooms and any other items are approximate and no responsibility is taken for any error, omission or mis-statement. This plan is for illustrative purposes only and should be used as such by any prospective purchaser. The services, systems and appliances shown have not been tested and no guarantee as to their operability or efficiency can be given.  
Made with Metropix ©2020